

RICOH
imagine. change.

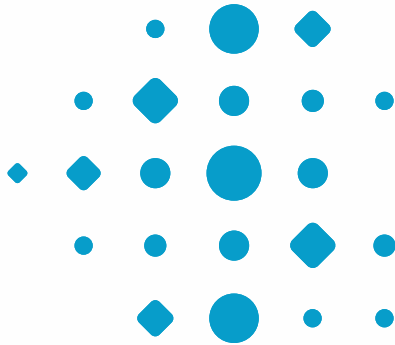

ScanSnap
iX2400



Connect your worlds
with one touch.

Scan, save and share at the touch of a button

Simplicity and High Performance at Your Fingertips

The ScanSnap iX2400 combines powerful, high-speed image processing with the signature one-touch scanning experience that users love. Designed for those who value speed, ease of use, and reliability, the iX2400 delivers high performance without the complexity of advanced settings or network issues—it's a USB-only model built for straightforward operation.

High Performance That Boosts Efficiency

The ScanSnap iX2400 is a powerful tool to streamline your daily tasks. Ready to scan in just 2.9 seconds**1 after opening the cover, it starts instantly with a simple one-button operation. With blazing-fast speeds of up to 45 pages per minute (double-sided, A4 colour at 300 dpi), it digitizes everything from contracts to receipts in seconds. Despite its compact size, the scanner holds up to 100 A4 sheets. For thinner and smaller documents like receipts, the included Receipt Guide ensures smooth scanning and still supports up to 50 sheets of A4 paper for greater convenience.

Whether you need to archive a pile of invoices at the end of the month, quickly digitize meeting handouts, or keep travel receipts organized for expense reports, the iX2400 makes the process fast and stress-free. Its speed and capacity mean less time spent at the scanner and more time focusing on your work.

Reliable USB-Only Connectivity

With a dedicated USB connection, the iX2400 only needs to be set up once. Once configured, simply plug into your PC and start scanning.

This streamlined design is perfect for users who prefer not to rely on Wi-Fi or for environments where wireless connections are restricted.

Reliable Paper Feeding Technology

Engineered with commercial-grade feeding technology, the iX2400 ensures stable paper handling and minimizes risks such as multi-feeds or document damage. Features like an ultrasonic sensor, precision brake roller, and automatic skew detection provide consistent performance and protect your important documents. From multi-page contracts to fragile receipts, you can scan with confidence knowing that your documents are safe.

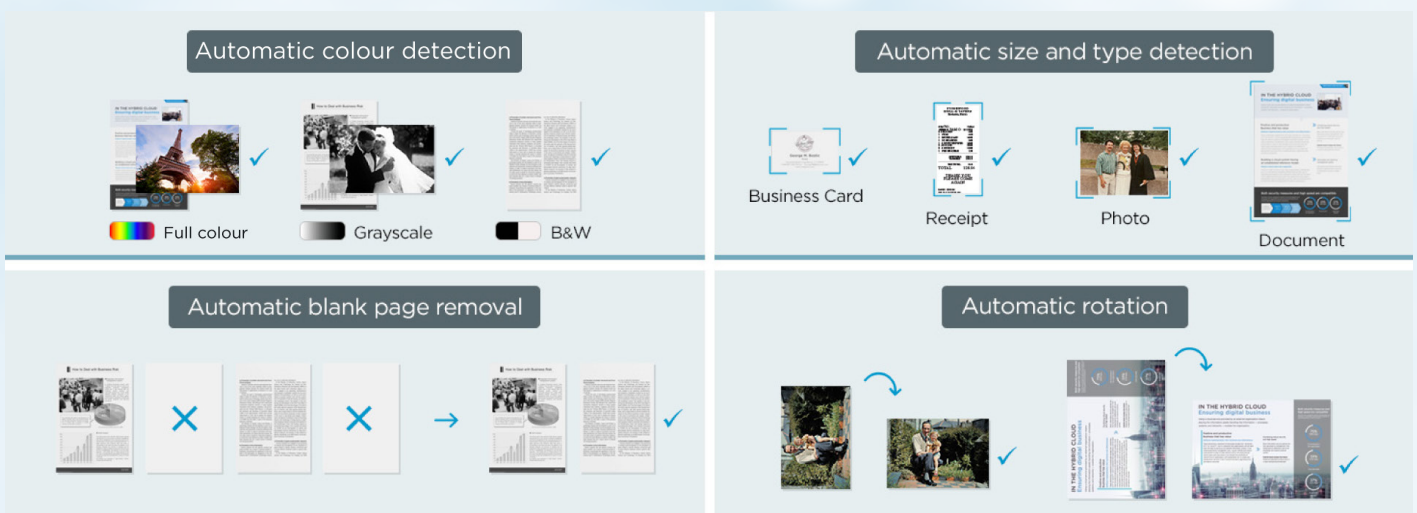

Assured, High-Quality Image

Thanks to PFU Clear Image Capture technology, the iX2400 delivers sharp, accurate scans. It reduces colour shifts and minimizes moiré patterns (irregular striped pattern). The ScanSnap iX2400 ensures optimal images even for photographs and documents with subtle colours and contrast.



The all-in-one solution for document management



ScanSnap Home^{*2} is a comprehensive document management software specially designed for ScanSnap scanners. Easily manage, edit, and utilize scans with just one application.

Accommodates any scanning environment

- Create profile icons to preset save-to destinations, colour settings, and much more.
- Save as PDF, searchable PDF, and JPEG for versatile utilization of scanned data.
- The Quick Menu enables you to select saving and integration destinations after scanning, which raises productivity. Users can drag and drop scanned data to popular applications or send it to the supported cloud services.

Environmentally conscious

The power consumption of the iX2400 during operation is approximately 13W, and the power consumption when turned off is less than 0.1W.

The production process is also environmentally conscious. The scanner body is made of 25% or more recycled plastic materials^{*3}, and the packaging materials, etc., are free of virgin plastics derived from fossil resources^{*4}.

*1 When in Fast mode. *2 There are a PC version and a mobile version. The iX2400 supports a PC version. For details of ScanSnap Home, please visit our website at: <https://www.pfu.ricoh.com/global/scanners/scansnap/sshome/>. *3 The percentage of recycled plastic used may vary depending on procurement conditions. *4 Pre-consumer materials, which have not been used by consumers and are generated during the manufacturing and molding processes, are used

General Specifications

Product name		ScanSnap iX2400 (Black)
Scanner type		ADF (Automatic Document Feeder), Duplex
Scanning colour mode		Colour, Grayscale, Monochrome, Automatic (Colour/Grayscale/Monochrome detection)
Image sensor		CIS x 2 (Front x 1, Back x 1)
Light source		3 Colour LED (Red/Green/Blue)
Optical resolution		600 dpi
Scanning speed*1 (A4 portrait)	Auto mode (Default)*2	Simplex/Duplex: 45 ppm
	Normal mode	Simplex/Duplex: 45 ppm (Colour/Grayscale: 150 dpi, Monochrome: 300 dpi)
	Better mode	Simplex/Duplex: 45 ppm (Colour/Grayscale: 200 dpi, Monochrome: 400 dpi)
	Best mode	Simplex/Duplex: 45 ppm (Colour/Grayscale: 300 dpi, Monochrome: 600 dpi)
	Excellent mode	Simplex/Duplex: 13 ppm (Colour/Grayscale: 600 dpi, Monochrome: 1,200 dpi)
Document size	Normal scan*3	Minimum: 50.8 x 50.8 mm (2 x 2 in.) Maximum: 216 x 360 mm (8.5 x 14.17 in.)
	With Photo Carrier Sheet (Option)	Minimum: 25.4 x 25.4 mm (1 x 1 in.) Maximum: 127 x 178 mm (5.0 x 7.0 in.)
	With Carrier Sheet (Option)	Minimum: 25.4 x 25.4 mm (1 x 1 in.) Maximum: 297 x 431.8 mm (11.69 x 17 in.)
	Long paper scanning*4	PC
Paper weight (Thickness)		40 to 209 g/m ² (11 to 56 lb) A8 size or less: 128 to 209 g/m ² (34 to 56 lb) Cards: 0.76 mm or less (Compliant with the ISO7810 ID-1 type) (Includes embossed cards in landscape orientation)
	ADF capacity*5	100 sheets (A4, 80 g/m ² or 20 lb)
Interface	USB	USB3.2 Gen1x1 / USB3.1 / USB3.0 / USB2.0 / USB 1.1 (Connector Type: Type-C)
Power requirement		AC 100 to 240 V, 50/60 Hz
Power consumption	Operating	Approx. 13 W
	Sleep mode	1.0 W or less
	When the power is off (default Normal mode)	0.1 W or less
	On standby in Fast mode	1.0 W or less
Operation environment		Temperature: 5 to 35 °C (41 to 95 °F) Relative humidity: 20 to 80% (Non-condensing)
Dimensions (W x D x H)		Min.: 292 x 161 x 159 mm (11.50 x 6.34 x 6.26 in.) (storage size) Max.: 292 x 477 x 286 mm (11.50 x 18.78 x 11.26 in.) (when the extension and the stacker are extended)
Device weight		3.2 kg (7.1 lb)
Environmental compliance		ENERGY STAR/RoHS
Multifeed detection		Overlap detection (Ultrasonic sensor), Length detection
Driver		ScanSnap Home (ScanSnap specific driver) •Windows: Does not support TWAIN/ISIS™ •macOS: Does not support TWAIN

*1 Scanning speeds may vary due to the system environment. For details, please visit our website at: <https://www.pfu-ricoh.com/global/scanners/scansnap/>. *2 Scans will be performed in 300 dpi (Colour/Grayscale) or 600 dpi (Monochrome) if shorter sides are less than 105 mm, and in 200 dpi (Colour/Grayscale) or 400 dpi (Monochrome) if shorter sides exceed 105 mm. *3 A3 scans are possible with use of A3 carrier sheets. *4 A document longer than A4 paper can be scanned one by one. Available in all modes except for "Excellent mode". *5 Up to 360 mm in Excellent mode. *6 Maximum capacity varies, depending upon paper weight.

Consumables

Description	Part number	Remarks
Roller Set	PA03860-0001	Lifetime: Every 200,000 sheets*1
Cleaner F1	PA03950-0352	100 ml bottle For use on the Brake roller and Pick roller
Cleaning Wipe	PA03950-0419	24 packets For use on the Brake roller and Pick roller
Cleaning Paper	CA99501-0012	10 sheets Use this non-woven sheet with Cleaner F1

*1 Replacement cycles are guidelines for using A4 documents (80 g/m² [20 lb]). These cycles vary depending on the type of documents scanned, how often the scanner is used and cleaned, and your operating environment.

*It is recommended to use original or approved accessories for consumables, options and cleaning kits, specially designed for your device. Device failures, troubles and damages arising from use of OEM or 3rd Party accessories may render your warranty invalid and incur charges for repair even during the warranty period.

Options

Description	Part number	Remarks
Carrier Sheets*1	PA03360-0013	Contains 5 sheets supporting photographs and various document sizes
Photo Carrier Sheets	PA03770-0015	Contains 3 sheets supporting photographs (E-size, L-size, King-size), postcards, and business cards
ScanSnap Bag	PA03951-0651	Stores one ScanSnap unit and accessories

*1 Although ScanSnap Carrier Sheets have a listed lifespan of 500 scans, the lifespan may vary with usage. ScanSnap Carrier sheets are intended to scan paper documents with weights of 209 g/m² or less. They also support the scanning of folded documents that are as large as 216 x 297 mm.

ScanSnap iX2400 System Requirements

• Windows

Operating systems		Windows 11 (64-bit) Windows 10 (32-bit / 64-bit)*2
Hardware requirements*3	CPU*4	Intel or Intel-compatible processors
	Display resolution	1,024 x 768 pixels or more
	Disk capacity*5,6	3.8 GB or more of free disk space

*1 ScanSnap scanners do not run with Windows 10 Enterprise 2015 LTSB and Windows 11 and 10 ARM-based PCs such as Surface Pro X (Microsoft). *2 Operate Windows in desktop mode. *3 The ScanSnap device may not work if the connected computer does not meet these requirements. *4 Scanning speeds may vary due to the system environment. *5 Indicated disk capacity requirements apply when downloading ScanSnap Home (for PC). *6 .NET Framework 4.8 or later must be installed. If it is not installed, it is installed with ScanSnap Home (for PC). Up to 4.5 GB of disk space is required for the installation.

*Please refer to the ScanSnap website for the latest support information of the driver and applications. Compatibility may differ depending on the software's version. *The system requirements may change depending on the support policies of the above system and third-party software.

• Mac

Operating systems		macOS Monterey 12 or later
Hardware requirements*1	CPU*2,3	Intel processor or Apple silicon
	Display resolution	1,024 x 768 pixels or more
	Disk capacity	2.5 GB or more of free disk space

*1 The ScanSnap device may not work if the connected computer does not meet these requirements. *2 The ScanSnap device also operates with Apple Silicon-based Mac computers. Please visit the ScanSnap website for latest support information. *3 Scanning speeds may vary due to the system environment.

*Compatibility may differ depending on software versions. Please visit the ScanSnap website for latest information on driver and application support. *The system requirements may change depending on the support policies of the above system and third-party software.

• Software

Windows	Mac
ScanSnap Home (for PC)*1	
ABBYY FineReader for ScanSnap™	

*1 ScanSnap Home (for PC) installation requires a computer and Internet. Please visit the company website for download information. <https://www.pfu-ricoh.com/global/scanners/scansnap/g-support/en/>. *The Internet is required to download and update the software. We recommend updating to the latest version using the Internet connection.

Accessories

•Safety Precautions •AC Cable •AC Adapter •USB Cable •Receipt Guide

This scanner is designed to digitize materials that can be reproduced lawfully, in accordance with applicable copyright regulations and other laws. ScanSnap users are responsible for how they use this scanner. It is imperative that ScanSnap users comply with all applicable local rules and laws, including, without limitation, copyright laws when using this scanner.

*ABBYY™ FineReader™ Engine © ABBYY. OCR by ABBYY. ABBYY and FineReader are trademarks of ABBYY Software, Ltd, which may be registered in some jurisdictions. *Android and Chrome OS are trademarks or registered trademarks of Google LLC. *Intel is a trademark of Intel Corporation or its subsidiaries. *ISIS is a trademark of Open Text. *Mac, macOS, iPad and iPhone are trademarks of Apple Inc., registered in the U.S. and other countries. *Microsoft and Windows are trademarks of the Microsoft group of companies. *ScanSnap, the ScanSnap logo and ScanSnap Home are registered trademarks or trademarks of Pfu Limited. *Other company names and product names are the trademarks or registered trademarks of the respective companies.



PFU Limited has determined that this product meets the ENERGY STAR guidelines for energy efficiency. ENERGY STAR and the ENERGY STAR mark are trademarks or registered trademarks of the U.S. Environmental Protection Agency.

Safety Precautions	Be sure to carefully read all safety precautions prior to using this product and use this device as instructed.	Do not place this device in wet, moist, steamy, dusty or oily areas. Using this product under such conditions may result in electrical shock, fire or damage to this product.
--------------------	---	---